

# NEUROPOWER

Powering Possibilities.  
Connecting Futures.



Line Interactive UPS ●  
**XR Series** ●

# ● XR Series

XR represents 'Xtended Runtime' where it is best defined by its capability to function with different battery ratings to provide longer flexible backup runtime to critical applications. This was made possible with the XR's specially designed battery charger where the charger offers a wide range of charging currents to ensure optimum battery charging for a prolonged battery lifecycle no matter what battery rating is used with the UPS.

Amongst all the line interactive UPS, this is a feature exclusive to the XR series making it ideal for small critical applications where long backup time is essential on top of basic power protection which includes clean, consistent and reliable power connectivity.

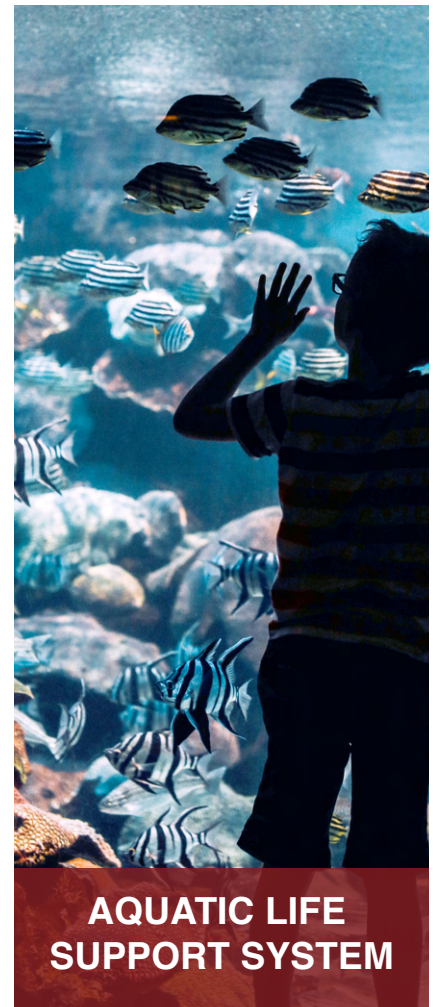

# XR Series

## 800VA-2kVA features

An exclusive model from Neuropower's Line Interactive UPS series, discover what XR series can offer as your preferred power solution.



Control panel of XR 1K/2K (Left) and XR 800 (Right)



Side view of XR 1K/2K (Left) and XR 800 (Right)

### 1. Designed using digital microprocessors

UPS output is controlled and configured accurately to meet the desired reliability standards.

### 2. Cold start and off charging mode

Turns on the UPS with battery power without using the input power supply and it can continue to charge the battery connected without turning the UPS on.

### 3. Comes with universal sockets for convenient plug-and-play regardless of 3 pins or 2 pins sockets

An easy and convenient feature that makes the UPS compatible with any country's standard plugs.

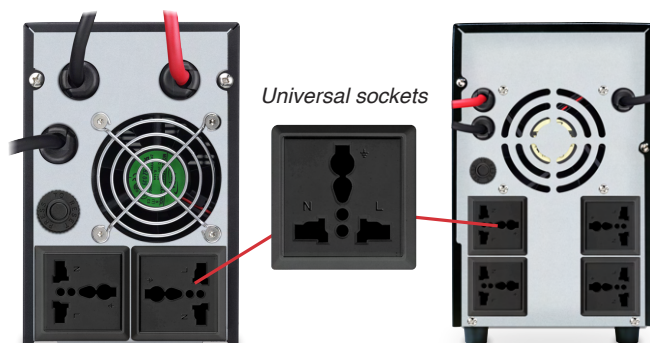

Rear view of XR 800 (Left) and XR 1K/2K (Right)





#### 4. UPS is designed to achieve extended runtime with high capacity external batteries

The UPS's specially designed battery charger provides a wide range of charging currents and is compatible with any battery ratings used. This ensures optimum battery charging for a longer battery lifecycle.

#### 5. Easy connection between batteries and UPS via UPS battery terminal

The external batteries can easily be connected to the UPS via the UPS battery terminal which is easily accessible for users.

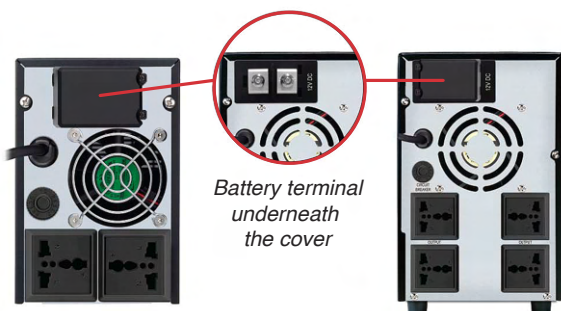

Rear view of XR 800 (Left) and XR 1K/2K (Right)

#### 6. Built in buck and boost automatic voltage regulator for voltage stabilization

Important for critical applications, this feature helps to reduce voltage fluctuations and instability to avoid equipment failure.

#### 7. Protected by resettable circuit breakers

Comes with an easily resettable circuit breaker for overload and surge protection on AC input or output and battery input sections.

#### 8. Auto restart function available

After full battery discharge from running in battery mode, UPS will auto restart from the low battery when the input AC power recovers.

# Technical Specification

Specification	Model	XR-800	XR-1K	XR-2K
	Power Rating (VA / W)	800 / 360	1000 / 600	2000 / 1200
Input	Voltage (VAC)	230		
	Acceptable Voltage Range (VAC)	140 - 300		
	Frequency Range (Hz)	50		
Output	AC Voltage Regulation (VAC)	230 ± 10%		
	Frequency Range (Hz)	50 ± 1		
	Transfer Time (ms)	Typical 4 to 8		
	Waveform (Batt Mode)	Simulated Sine Wave		
	Outlet	2 x Universal Sockets	4 x Universal Sockets	
Battery	Battery Voltage (VDC)	12		24
	Floating Charging Voltage (VDC)	13.7 ± 2%		27.4 ± 2%
	Configurable Charging Current (A)	2.5 / 6 / 10	5 / 10 / 15 / 20	
Protection	Full Protection	Overload, Discharge and Overcharge Protection		
Indicators	Line Mode	Green LED		
	Battery Mode	Yellow LED flashing		
	Fault	Red LED		
Audible Alarm	Battery Mode	Beeping every 10 sec		
	Low Battery	Beeping every sec		
	Overload	Beeping every 0.5 sec		
	Battery Replacement Alarm	Beeping every 2 sec		
	Fault	Continuous Beeping		
Physical	Dimension, W x D x H (mm)	97 x 359 x 146	145 x 396 x 220	
	Net Weight (kg)	5.8	9.0	13.6
	Temperature (°C)	0 to 40		
Operating Environment	Humidity	0 to 90% Relative Humidity (Non-Condensing)		
	Noise Level @ 1 Meter (dB)	< 40		

● In the interests of continuous product improvement, all specifications are subject to change without notice.



**NEUPOWERS (M) SDN BHD** 200301034724 (637145-P)

📍 No. 23, Jalan Serendah 26/41, Hicom Industrial Estate,  
40400 Shah Alam, Selangor.

✉ [enquiry@neuropower.com.my](mailto:enquiry@neuropower.com.my) ☎ 1300 88 6772

🌐 [www.neuropower.com.my](http://www.neuropower.com.my) 📘 NeuropowerMy

